



**Elevator
Trading**
& Services

Kompact Lift

Technical description

1.- *Kompact Lift* introduction.

Kompact Lift, is the ideal solution for modernization projects into existing houses, with residential traffic application, when **Pit and/or Headroom cannot fulfil the minimum EN.81 requirements.**

Kompact Lift can be installed both indoors and outdoors.

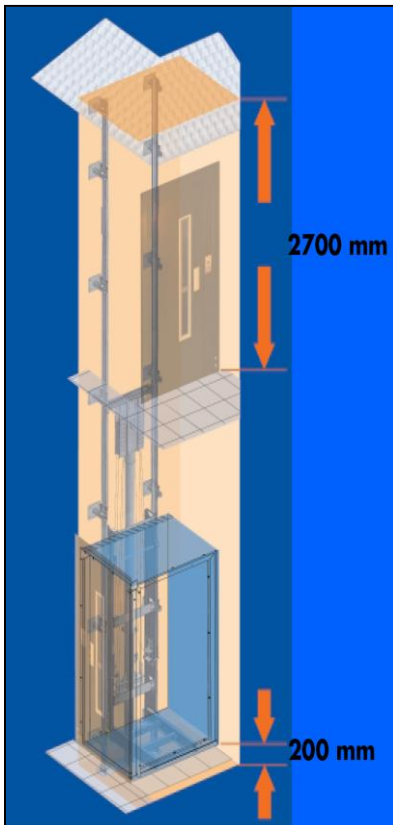

I. **Kompact Lift**

- Connection to 400 VAC (3 phases)
- From 3 people (225 kg.) up to 8 people (630 kg)
- **Minimum space requirements (Pit only 200 mm **, Headroom requirements in the top floor only 2,700 mm.)**
- Hydraulic operation (2:1 traction)
- Low power consumption
- Very advantageous proportion of cabin size and exterior dimensions of the lift shaft

- **Certificate N° 33026077/0093 by ICICT/ Group TUV Rheinland, tested according to the EN 81.2 (98)**
- **Certification for EN 81.2 Pit / Headroom exception included.**

II. **Optional Lift Shaft System** (see UniLift technical description)

- Self supporting
- Easy installation without dirt, elements to be screwed together.
- modular structure adapts to any requirements

III. **Technical Data**

Rated Load	225 kg	300 kg.	450 kg.	630 kg.
Speed	0,62 m/s.			
Travel	Maximum 20 mts.			
Minimum Pit required	200 mm.			
Minimum Headroom required	2.700 mm.			
Power Supply	230 Vac. / 400 Vac. 50 Hz.			
Cabin accesses	Single, Double 90°, Double 180°			
Operation	Push Button or Down collective.			
Motor Power (kW max.)	9,57	11,78	11,78	14,74
Levelling accuracy	+/- 5 mm.			
Safety Brake	Instantaneous.			
Apron	Folded in lower floor.			

2. Cabin

I. Cabin Size & Access

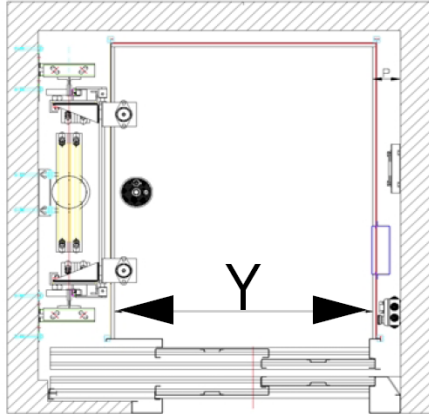

Interior dimensions of cabin: **customized**

Maximum car depth (D) : **1.400 mm**

Maximum car width (Y) : **1.200 mm**

Height of the cabin : **2.050 mm**

Cabin accesses: **1 or 2 open sides.** (90° or 180°).

Door Standard dimensions: 600, 700, 800, 900 mm.

Cabin door: Automatic 2 panels. (central / side opening)

BUS folding car door (optional) : 600, 700, 800, 900 mm.







Finishing : Stainless Steel

Corridor doors: Automatic 2 panels.

Optional : Folding doors.

Finishing: Epoxy painted.

II. Cabin Decoration & Controls.

FireBrick (≅ RAL 3011)		Mirror:	<ul style="list-style-type: none"> On the rear wall. (half the cabin height)
		Walls:	<ul style="list-style-type: none"> Melamine panels. Glass or stainless steel (satin finishing) as option (extra price) Stainless steel skirting
Soft Gold (≅ RAL 1015)		Floor:	<ul style="list-style-type: none"> Anti-slip flooring (grey PVC) Optionally : prepared for marble (by others)
Pigeon Blue (≅ RAL 5014)		Operating controls:	<ul style="list-style-type: none"> DMG Push buttons integrated into a vertical column stainless steel support in the side panel, with Braille engraving. (floor call, open door, alarm as standard. Others, by option)
Pale Grey (≅ RAL 7035)			<ul style="list-style-type: none"> Key-operated switch to unlock the push buttons. Photocell in car entrance.
Walnut Caramel		Ceiling & Lighting:	<ul style="list-style-type: none"> Elegant White or Black painted steel plate Lighting integrated in the cabin ceiling Light turns off automatically when the landing door is opened and stays on as long as the lift is running.
Maple Woodline			<ul style="list-style-type: none"> 10 seconds later it is turned off automatically. Emergency Lighting
Light Cinnamont		Hand rail.	<ul style="list-style-type: none"> Nickel-plated or in Stainless steel.
			<ul style="list-style-type: none"> Other special features available on demand



3. Added Safeties

Kompact Lift includes those additional safeties to compensate the not-fulfilment EN-81.2 paragraphs related minimum distances in Pit and Headroom.

3.1.- Related to Reduced Headroom

These paragraphs are : 5.7.1.1b; 5.7.1.1c; 5.7.1.1c2 and 5.7.1.1d

The included additional safeties to compensate the reduced headroom risks are :

- **Electrical device** to switch off the lift power if going up in inspection speed, when cabin arrives to 1,5 mts. from the upper part (ceiling) of shaft.
- **2 mechanical folding safety protection beams** in the roof of cabin to avoid car position near than established in EN81.2 / 5.7.1.b. These beams will include electrical contacts and bumpers.
- **Redundant electrical contacts in corridor door locks** (all apart from lower level) to be activated when emergency key is turned to open the door. These contacts will block the Control Panel.
- Unblocking Control Panel only possible by **safety push button** in Control Cabinet.

3.4.- Related to Reduced Pit.

The paragraphs are : 5.7.2.3a; 5.7.2.3b; 5.7.2.3b-1; 5.7.2.3b-2 and 5.7.2.3c

The included additional safeties to compensate the reduced pit risks are :

- One **mechanical folding safety beam** in the pit to avoid car position near than established in EN81.2 / 5.7.2.3.a. // 5.7.2.3.b. // 5.7.2.3.c.. This beam will include electrical contact to block the control. Folding / Unfolding the pit prop will be actuated from corridor in lower level (not inside the pit).
- **Folding Toe Guard** below the cabin with magnetic unfolding control when corridor door is opened by emergency key. The toe guard will return to folding position when cabin arrives to lower floor.
- **Redundant electrical contacts in lower level corridor door lock** to be activated when emergency key is turned to open the door. These contacts will block the Control Panel.
- Unblocking Control Panel only possible by **safety push button** in Control Cabinet.

3.5.- Additional tests included in the certification.

- Roof of the cabin in accordance with EN 81.2, paragraph 8.13.1.
- Cabin panels in accordance with EN 81.2, paragraph 8.3.2.1.
- Safety brake in accordance EN 81.2 paragraph 9.8.1

3. Dimensions

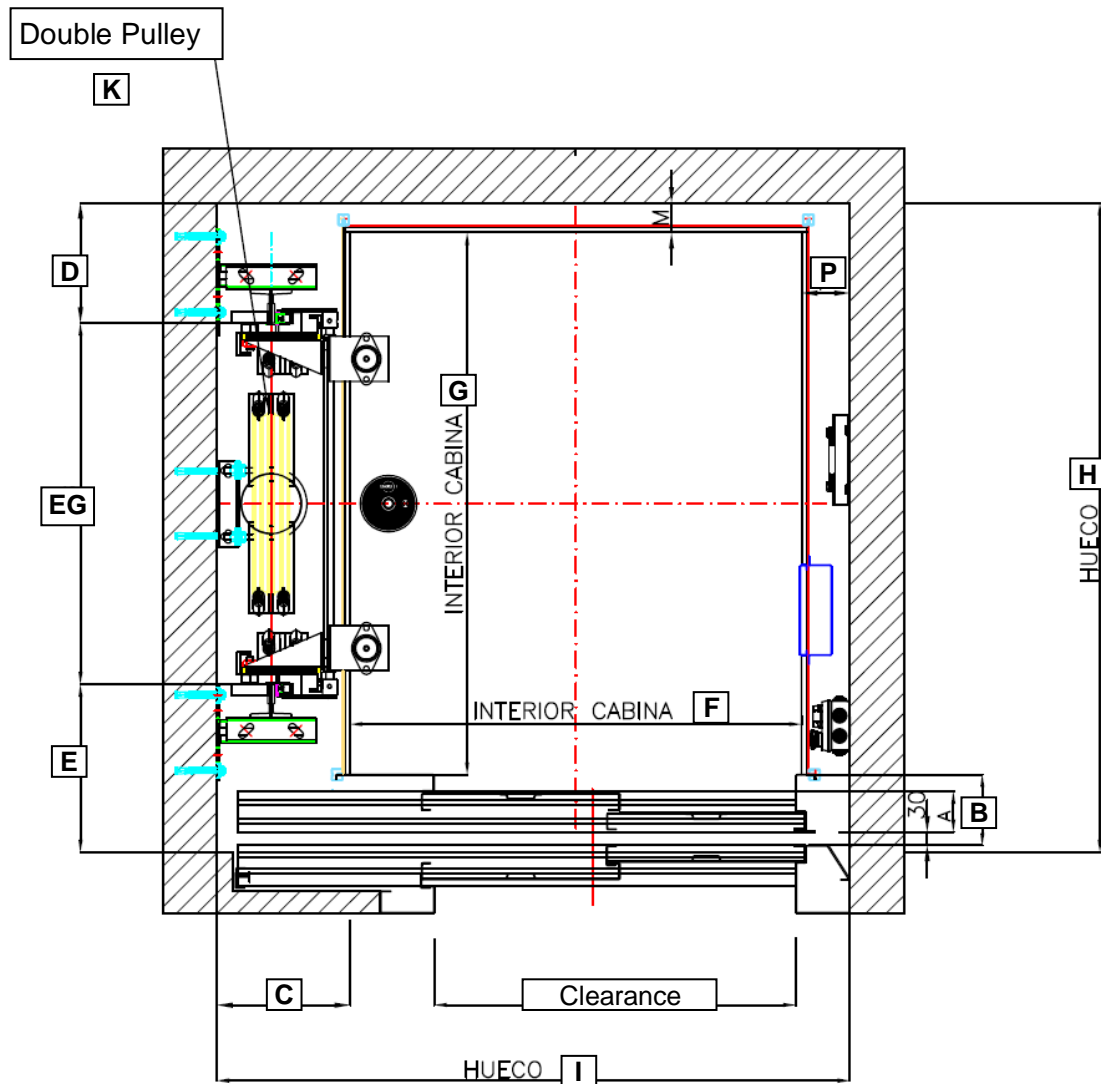

The design and production of the **Kompact Lift** shaft system is customized. Therefore no fixed dimensions are defined. The dimensions indicated in the above drawing are just an indication for project calculations. It enables you to define the approximate required space for the shaft with a determined cabin size or what cabin size might be achieved with a determined lift shaft.

Type	Minimum dimensions (mm.)					
	EG	A	B	C	D	E
KpLift-300	650	75	157	335	140	290
KpLift-450	800	75	157	335	145	300
KpLift-630	800	75	157	370	145	300

Type	Minimum dimensions (mm.)					Door clearance	FxG max.
	FxG min..	H	I	K	P		
KpLift-300	0,79 m2	1080	1290	320	100	700 mm.	0,9 m2
KpLift-450	1,17 m2	1245	1440	400	100	800 mm.	1,3 m2
KpLift-630	1,45 m2	1245	1440	400	100	800 mm.	1,6 m2

4. Metal Cabinet (option).

In case of room machine not available, both Hydraulic pump and Control System may be installed inside a Homologated Metal Cabinet.

Dimensions (W x D x H)	KpLift 300	950 mm. x 400 mm. 2.100 mm.
	KpLift 450 & 630	1030 mm. x 620 mm. 2.100 mm.
Access doors	2 panels central opening.	
Finishing	Painted RAL 7035	
Hose	5 mts. included.	

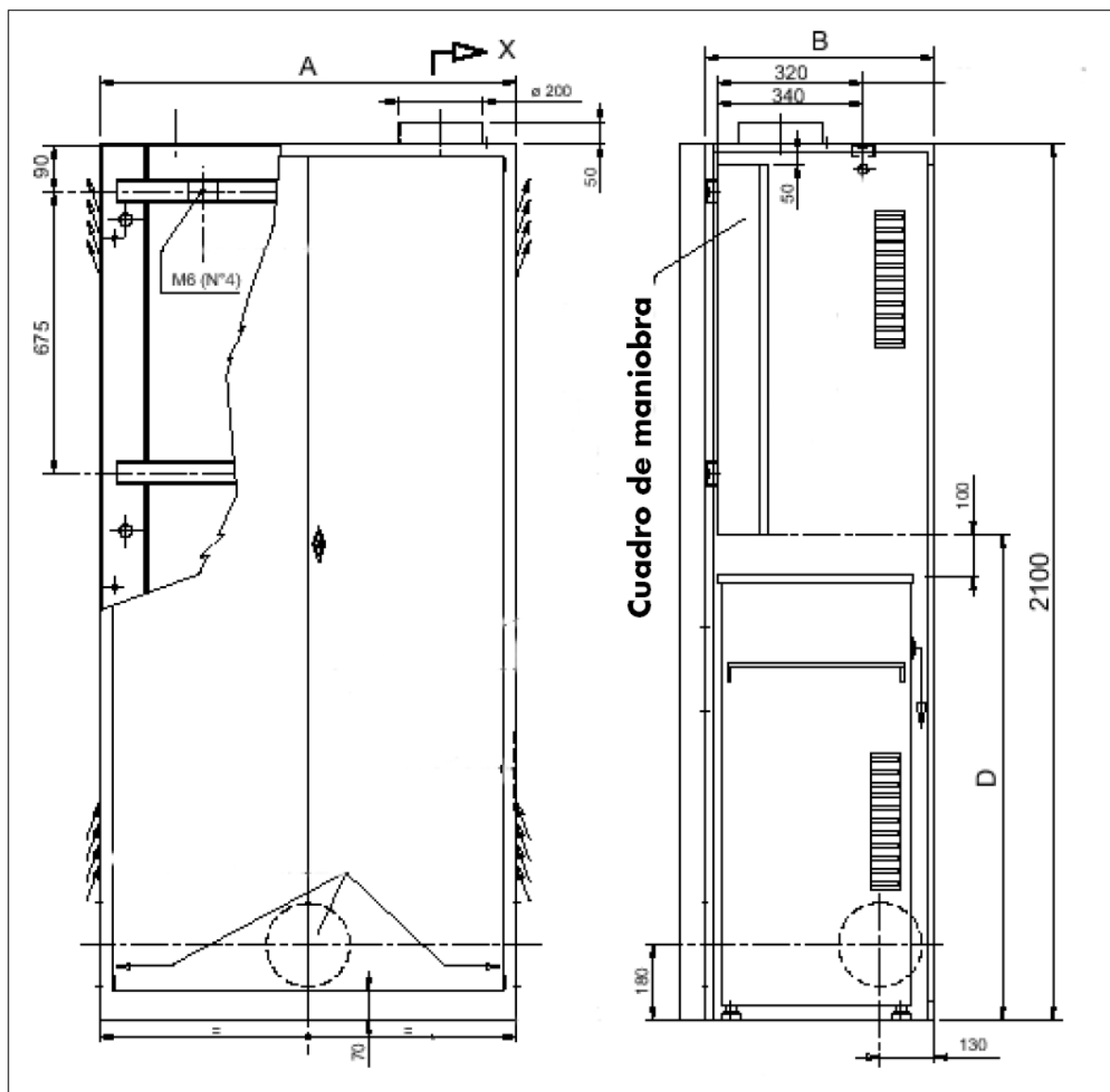

5. Layouts

CL-SF model

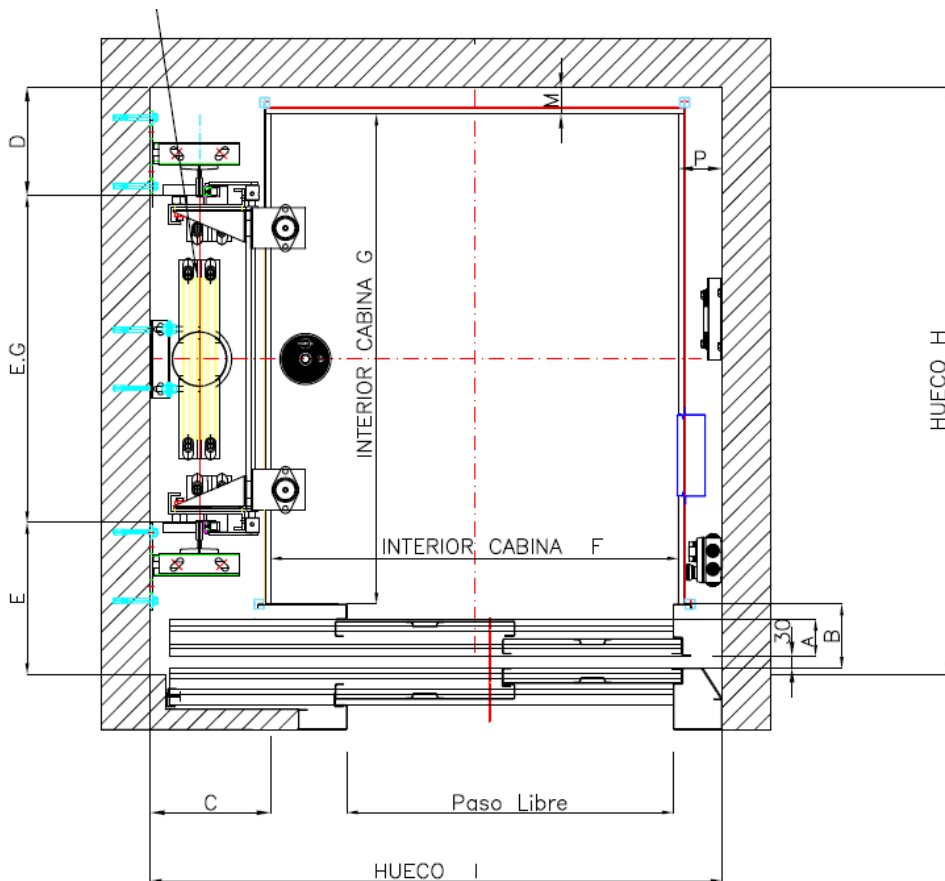
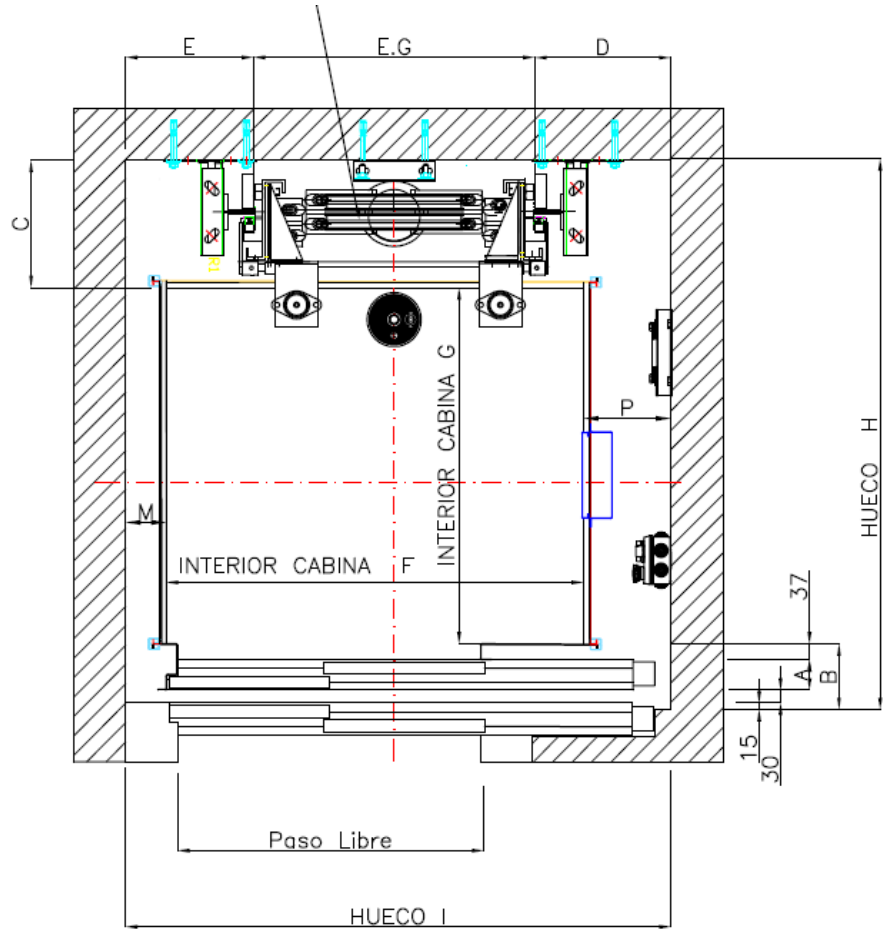

CL-SL Type

CL-DR Type

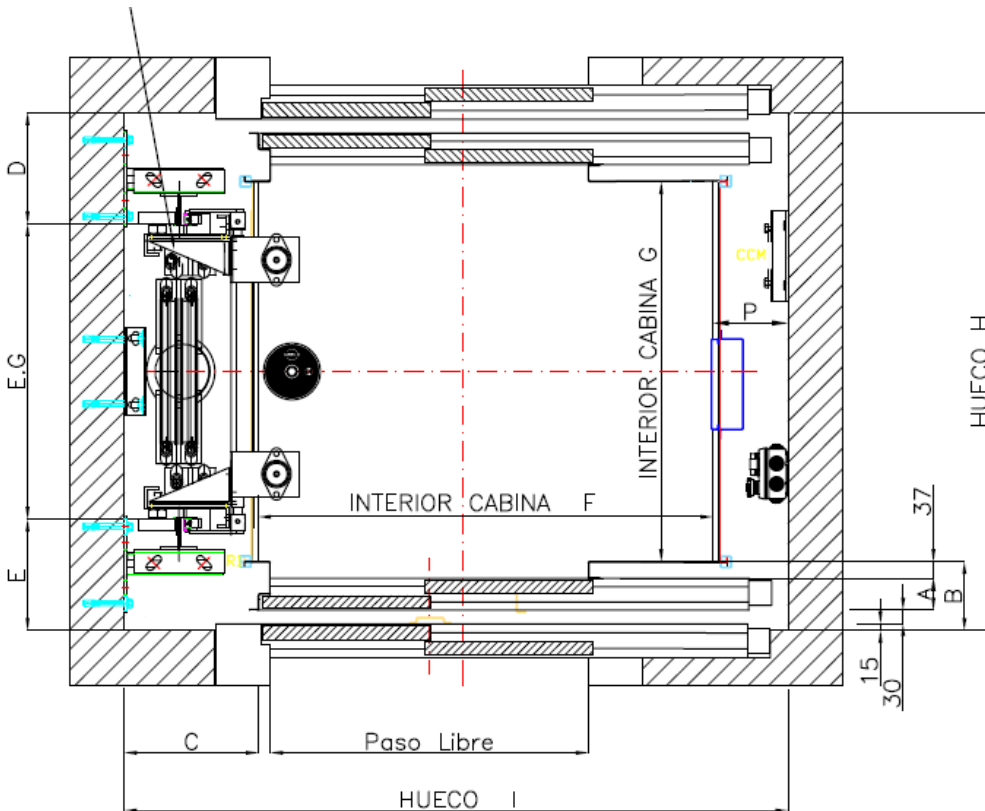
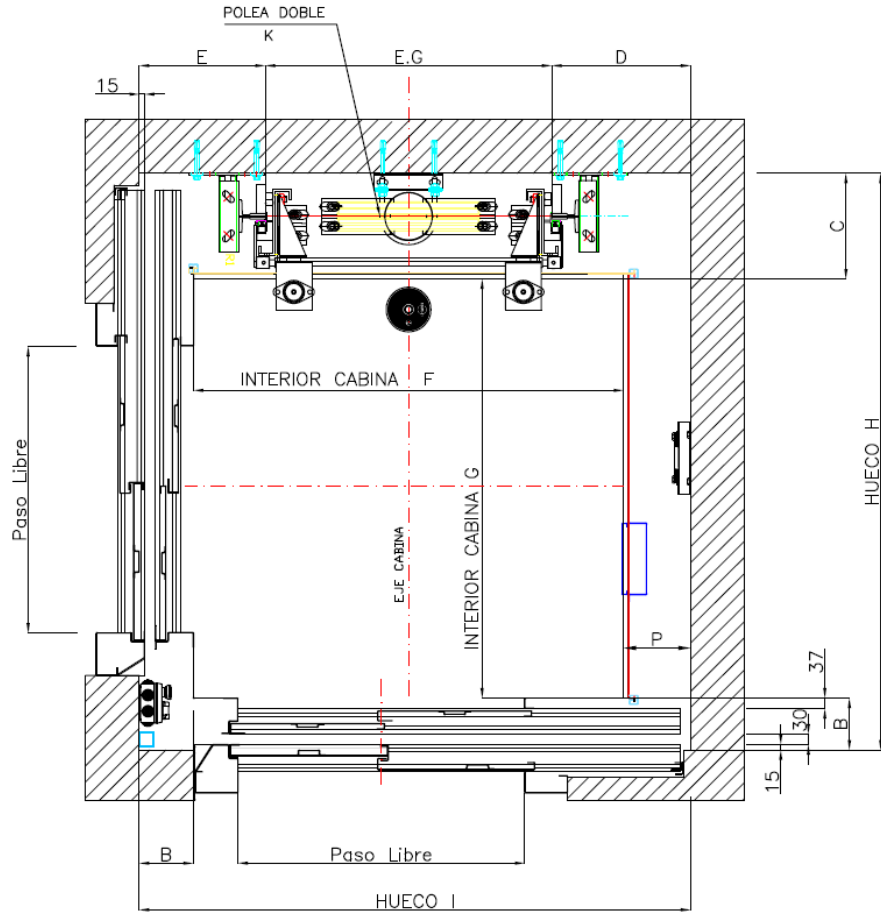

CL-DF Type



5. EC Type Examination



CERTIFICADO DE EXAMEN C.E. DE TIPO
EC TYPE-EXAMINATION CERTIFICATE

Producto Certificado Product Certificate	Ascensor Modelo Model lift	Nº Certificado Certificate number	ICICT / LD-VB / 005 / 04 / B
--	--------------------------------------	---	-------------------------------------

Organismo Notificado Notified Body	ICICT, S.A.	Nº de Identificación 0093
	Parque de Negocios "Mas Blau" Edificio OCÉANO C/ Garrotxa, 10-12. El Prat de Llobregat 08820 – Barcelona (ESPAÑA)	

Nombre Fabricante Manufacturer's name	C/ Mogoda,20-24 Pol.Ind.Can Salvatella 08210 – BARBERA DEL VALLES (Barcelona)
---	--

Propietario del Certificado Name and address of Certificate holder	C/ Mogoda,20-24 Pol.Ind.Can Salvatella 08210 – BARBERA DEL VALLES (Barcelona)
--	--

Fecha de Presentación Date of submission	13 de Septiembre de 2004
--	--------------------------

Fecha del Examen de Tipo Date of EC type examination	5 de Noviembre de 2004
--	------------------------

Directiva CE aplicada EC-Directive	Directiva 95/16/CE de 29 de Junio de 1995 EC-Directive 95/16/EC of 29.06.1995
--	--

Norma Europea European Standard	UNE EN 81-2
---	-------------

Declaración Statement	<i>El alcance de este ascensor modelo con sus variantes, queda establecido en cada una de las tablas contempladas en el anexo a este certificado</i>
	<i>The scope of application of this model lift and its variants is stated in the tables of the annex to this certificate.</i>

Modelo / Tipo Model/type	DHE
	Martín Martí García Responsable Técnico



El Prat de Llobregat a 30 de Septiembre de 2005

